

ISO A1 594mm x 841mm
 Approved:
 Checked:
 Designer:
 Project Management Initials:
 11/02/2016
 P:\PROJECTS\6050476\DRAWING\REPORT\EIA\A1_780.dgn
 Plot File by: Song\YN

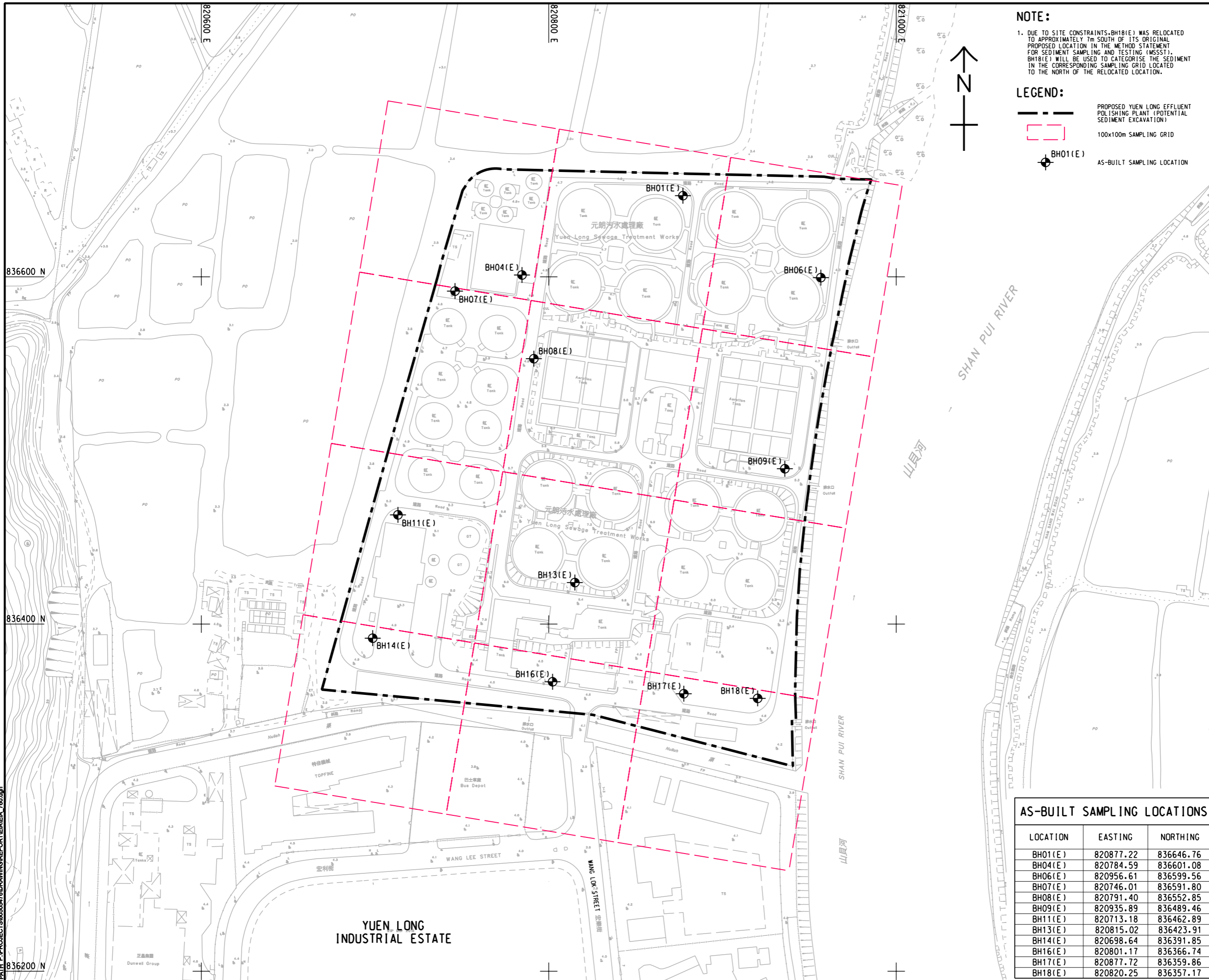

NOTE:

1. DUE TO SITE CONSTRAINTS, BH18(E) WAS RELOCATED TO APPROXIMATELY 7m SOUTH OF ITS ORIGINAL PROPOSED LOCATION IN THE METHOD STATEMENT FOR SEDIMENT SAMPLING AND TESTING (MSSST). BH18(E) WILL BE USED TO CATEGORISE THE SEDIMENT IN THE CORRESPONDING SAMPLING GRID LOCATED TO THE NORTH OF THE RELOCATED LOCATION.

LEGEND:

- PROPOSED YUEN LONG EFFLUENT POLISHING PLANT (POTENTIAL SEDIMENT EXCAVATION)
- 100x100m SAMPLING GRID
- BH01(E) AS-BUILT SAMPLING LOCATION



PROJECT
YUEN LONG EFFLUENT POLISHING PLANT - INVESTIGATION, DESIGN AND CONSTRUCTION

CLIENT
 渠務署
 Drainage Services Department

CONSULTANT
 AECOM Asia Company Ltd.
 www.aecom.com

SUB-CONSULTANTS
 分判工程顧問公司

ISSUE/REVISION

I/R	DATE	DESCRIPTION	CHK.

STATUS

SCALE
 1:1000
DIMENSION UNIT
 METRES

KEY PLAN

AS-BUILT SAMPLING LOCATIONS

LOCATION	EASTING	NORTHING
BH01(E)	820877.22	836646.76
BH04(E)	820784.59	836601.08
BH06(E)	820956.61	836599.56
BH07(E)	820746.01	836591.80
BH08(E)	820791.40	836552.85
BH09(E)	820935.89	836489.46
BH11(E)	820713.18	836462.89
BH13(E)	820815.02	836423.91
BH14(E)	820698.64	836391.85
BH16(E)	820801.17	836366.74
BH17(E)	820877.72	836359.86
BH18(E)	820820.25	836357.17

PROJECT NO.
 60505476
CONTRACT NO.
 CE 3/2015 (DS)

SHEET TITLE
 AS-BUILT SEDIMENT SAMPLING LOCATIONS

SHEET NUMBER
 60505476/EIA/FIGURE 6.1

This drawing has been prepared for the use of AECOM's client. It may not be used, modified, reproduced or relied upon by third parties, except as approved by AECOM or as required by law. AECOM accepts no responsibility, and disclaims any liability whatsoever, for any party that uses or relies on this drawing without AECOM's express written consent. Do not scale this document. All measurements must be obtained from the stated dimensions.